

# Neat Frame

Personal device user guide  
For Zoom

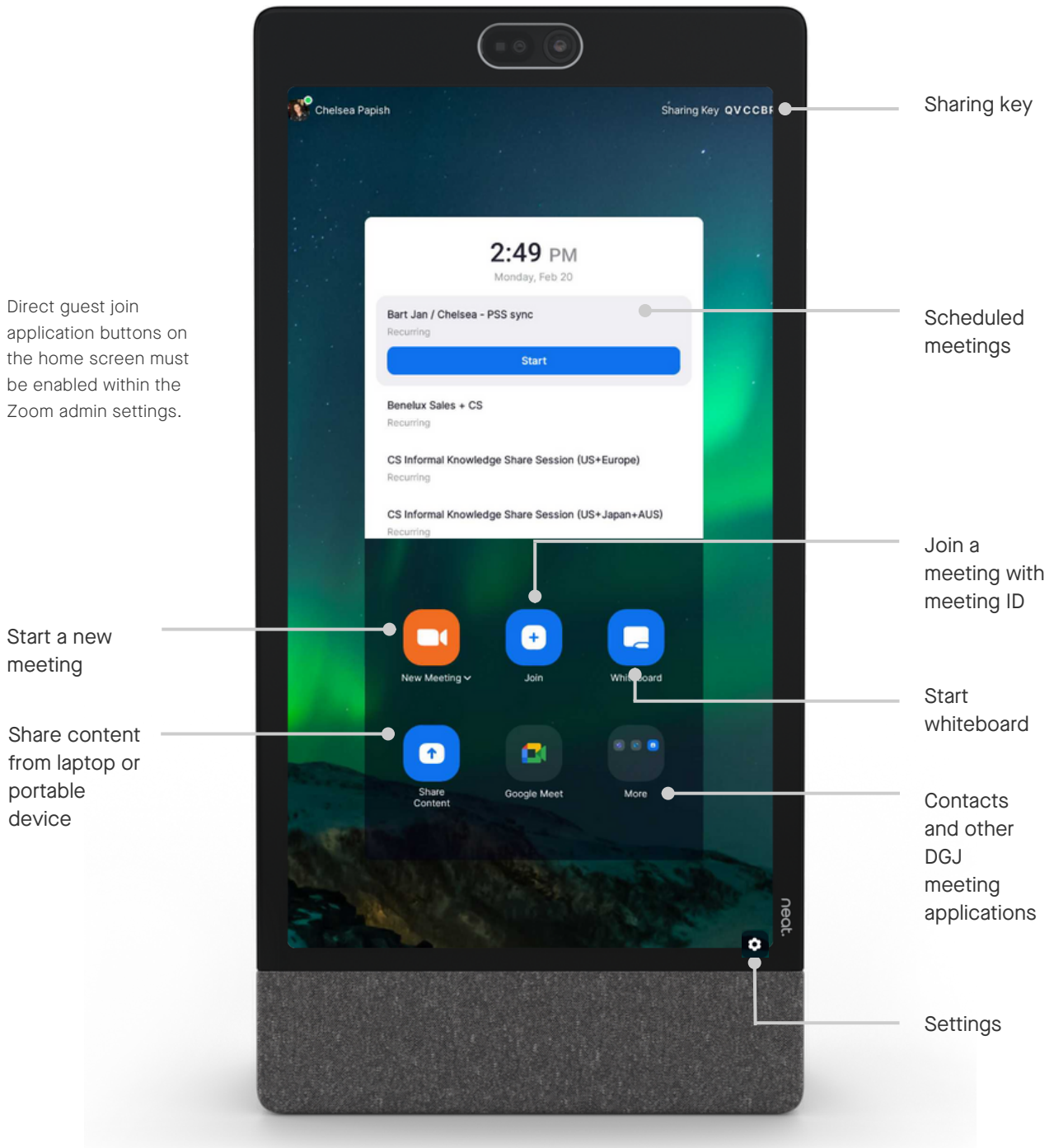

# Neat Frame home



# In-meeting



To adjust camera settings and while in a meeting, swipe with one finger from the right side of the Pad towards the left. A slide out will appear with the auto-framing options: Individuals, Group, Off.

Tap "More" for

- Raise hand
- Security
- Camera control
- Breakout rooms
- Virtual background
- Manage Participants
- Start/stop Recording
- Chat
- Settings
- Volume

End meeting for all or leave

Mute or unmute in a meeting

Start or stop video

Share content from laptop or portable device

Change to speaker, thumbnail or gallery view

Start Whiteboard



# Tips and tricks

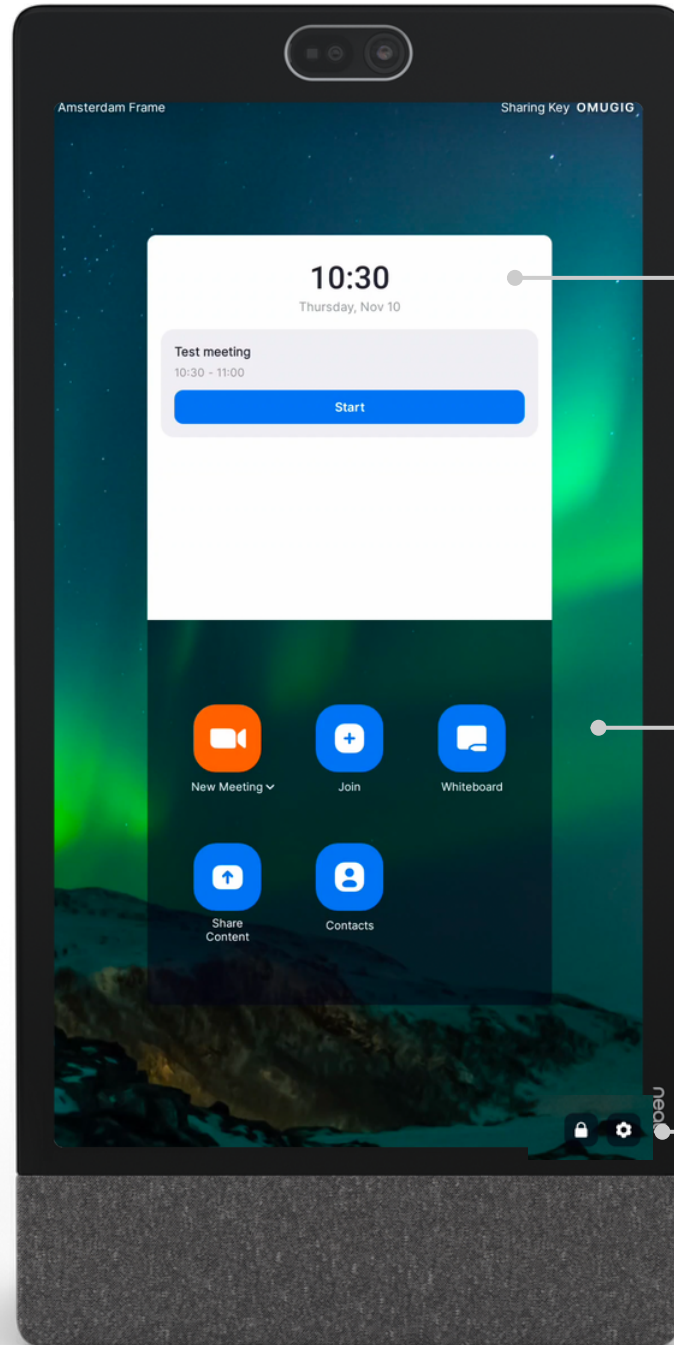

Scroll down to refresh meetings



Tap anywhere outside the pop-up to have the "Lock" and "Settings" icons appear at the bottom right corner.



To enable screen lock, click on "Settings." In "Settings" - "General," scroll down to "Screen Lock." Drag the toggle to the right.

